

## 产品特点

- 精度高，衰减范围广
- 低插入损耗和高 PER
- 高稳定性和可靠性



## 应用范围

- 光通信系统测试
- 光纤组件测试
- Fiber Senso

## 技术参数

Type	Value
Operating Wavelength (nm)	1550
Bandwidth (nm)	$\pm 40$
Attenuation Range (dB)	0.8~60
Insertion Loss	$\leq 0.8$
ER (dB)	$\geq 18$
Return Loss (dB)	$\geq 50$
Fiber Type	Fujikuar PM1550 Panda fiber
Package Dimension (mm)	$26 \times 18 \times 8 \pm 0.2$
Maximum Power Handling (mW)	300
Axis Alignment	Both axis work
Operating Temperature (°C)	-0 to +70
Storage Temperature (°C)	-40 ~ +85

For device with connector, IL is 0.3dB higher, RL is 5dB lower, ER is 2dB lower

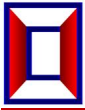

## 产品尺寸

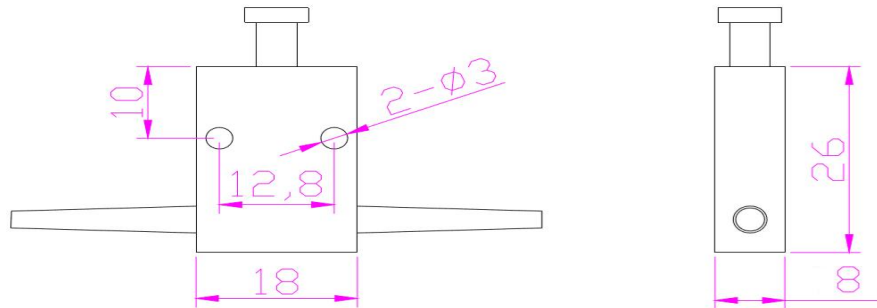

## 订购信息 HC-PMVOA-A-B-C-D-E

	A	B	C	D	E
PMVOA	Wavelength	Adjustment Type	Pigtail Type	Length	Connector
	1550=1550nm	1=Hand Adjustment	1=250um 2=900um loose tube 3=3mm loose tube	H=0.5m 8=0.8m 1=1.0m 5=1.5m 2=2m	0=None 1=FC/UPC 2=FC/APC 3=SC/APC 4=SC/UPC 6=LC/PC