

Performance Specifications

Parameter	4 Channel	8 Channel	16 Channel	18 Channel
	Mux/Demux	Mux/Demux	Mux/Demux	Mux/Demux
Channel Wavelength (nm)	1270~1610/1271~1611			
Center wavelength Accuracy (nm)	±0.5			
Channel Spacing (nm)	20			
Channel Passband (@-0.5dB bandwidth (nm))	+/-7.5/+/-6.5			
Insertion Loss (dB)	≤1.5	≤2.5	≤3.5	≤3.5
Channel Uniformity (dB)	≤0.6	≤1.0	≤1.5	≤1.5
Channel Ripple (dB)	0.3			
Isolation (dB)	Adjacent	>30		
	Non-adjacent	>40		
Insertion Loss (dB)	Express with filter	>30		
	Express without filter	>12		
Inertion Loss Temperature Sensitivity (dB/°C)	<0.005			
Wavelength Temperature Shifting (nm/°C)	<0.002			
Polarization Dependent Loss (dB)	<0.1			
Polarization Mode Dispersion (ps)	<0.1			
Directivity (dB)	> 50			
Return Loss (dB)	> 45			
Maximum Power Handling (mW)	300			
Operating Temperature (°C)	-40~+85			
Storage Temperature (°C)	-40~+85			
Package dimension (mm)(LGX box)	L155.5xW102(129)xH29			

Notes: 1、 Above specifications are for devices without connector.2、 Specifications may change without notice.

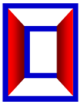

Dimension (Unit:mm)

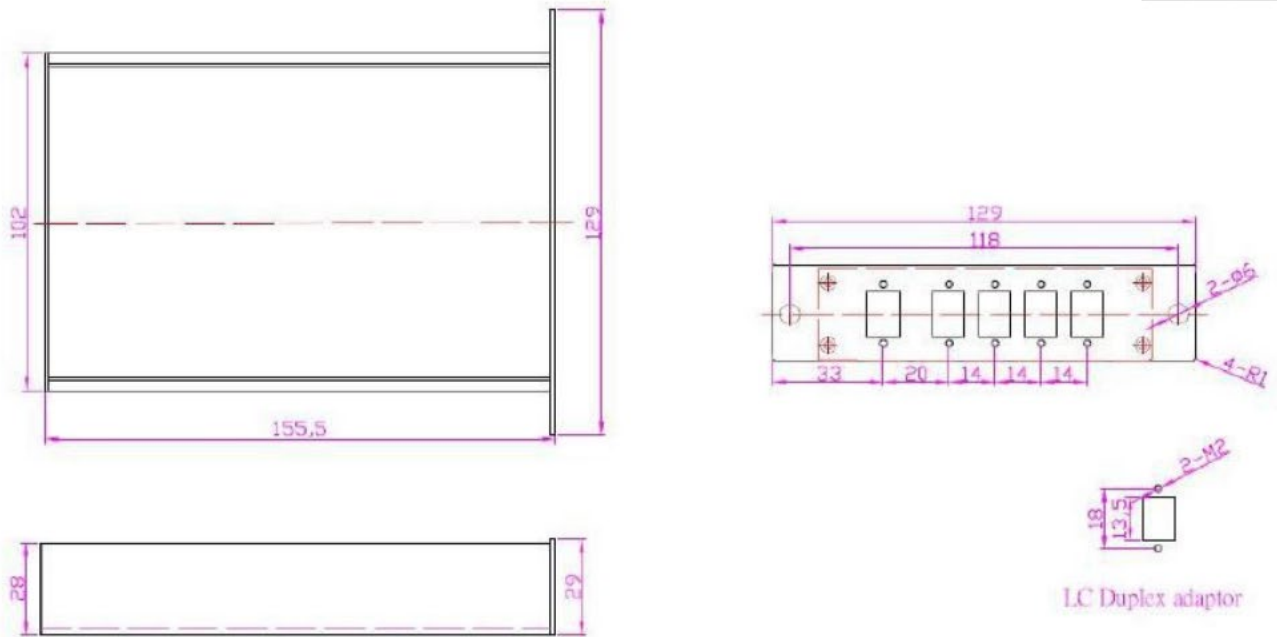

Order information: HC-CWDM-A-B-C-D-E-F

A	B	C	D	E	F
Number of Channels	Configuration	Fiber Type	Fiber Length	Connector	1st Channel
04: 4 Channel	01:MUX	01: Bare fiber	01:1m	01: None	27:1270nm
08: 8 Channel	02:DEMUX	02: 900um loose tube	02:2m	02:FC/APC	29:1290nm
16:16 Channel	03:OADM	03: 2mm Cable	03: Specify	03:FC/UPC	47:1470nm
18:18 Channel		04: 3mm Cable		04:SC/APC	49:1490nm
0N: N Channel				05:SC/UPC	57:1570nm
				06:LC	61:1610nm
				07:ST	07: special