



Feature

- Compact structure
- Low IL
- Fast switch time

Application

- PON Network
- Protection
- Instrumentation
- Network monitor

Specifications

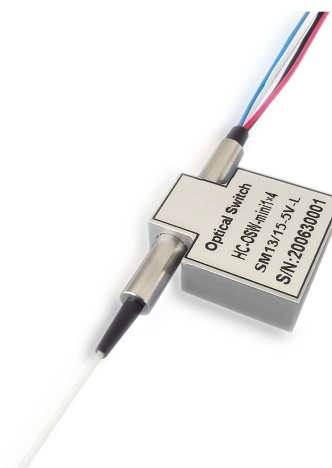

Parameters	Specifications	Unit
Operating Wavelength	1260~1620(SM)、850(MM)	nm
Insertion Loss	≤ 1.2	dB
Wavelength Dependent Loss	≤ 0.25	dB
Polarization Dependent Loss	≤ 0.05	dB
Temperature Dependent Loss	≤ 0.25	dB
Return Loss	SM ≥ 50 MM ≥ 30	dB
Cross Talk	SM ≥ 55 MM ≥ 50	dB
Switch Time	≤ 8	ms
Repeatability	$\leq \pm 0.02$	dB
Durability	$\geq 10^7$	times
Operating Voltage	3 or 5	V
Switch Type	Non-Latching/Latching	
Operating Temperature	-20~+70	°C
Storage Temperature	-40~+85	°C
Optical Power	≤ 500	mW
Dimension	23.0L×27.0W×8.2H	mm



Pin Configurations

Latching Type:

Type	Optical Route	Relay	Electric Drive				State Sensor			
1×4			Pin 1	Pin 5	Pin 6	Pin 10	Pin	Pin 3-4	Pin 7-8	Pin 8-9
Latching	Input- Port 1(Black)	Relay1	--	--	GND	V+	Clos	Open	Open	Close
		Relay2	V+	GND	--	--	Ope	Close	Close	Open
	Input- Port 2 (red)	Relay1	V+	GND	--	--	Ope	Close	Close	Open
		Relay2	--	--	GND	V+	Clos	Open	Open	Close
	Input- Port 3(blue)	Relay1	--	--	GND	V+	Clos	Open	Open	Close
		Relay2	--	--	GND	V+	Clos	Open	Open	Close
	Input- Port 4(White)	Relay1	V+	GND	--	--	Ope	Close	Close	Open
		Relay2	V+	GND	--	--	Ope	Close	Close	Open

Non-Latching Type:

Type	Optical Route	Relay	Electric Drive				State Sensor			
1×4			Pin 1	Pin 5	Pin 6	Pin	Pin 2-3	Pin 3-4	Pin 7-8	Pin 8-9
Non-Latching	Input- Port 1(Black)	Relay1	--	--	--	--	Close	Open	Open	Close
		Relay2	V+	--	--	GND	Open	Close	Close	Open
	Input- Port 2 (red)	Relay1	V+	--	--	GND	Open	Close	Close	Open
		Relay2	--	--	--	--	Close	Open	Open	Close
	Input- Port 3(blue)	Relay1	--	--	--	--	Close	Open	Open	Close
		Relay2	--	--	--	--	Close	Open	Open	Close
	Input- Port 4(White)	Relay1	V+	--	--	GND	Open	Close	Close	Open
		Relay2	V+	--	--	GND	Open	Close	Close	Open

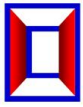

Dimension(mm)

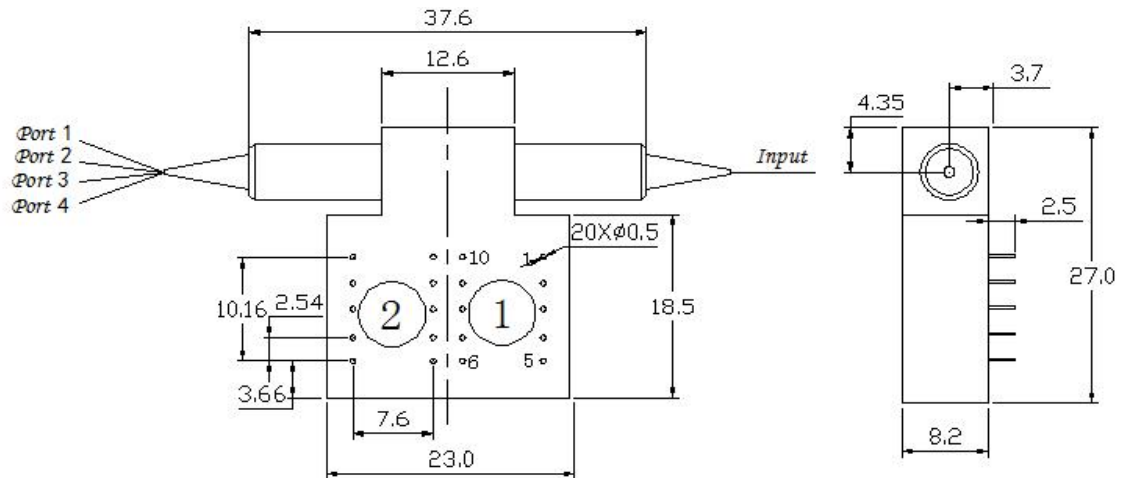

Optical Route

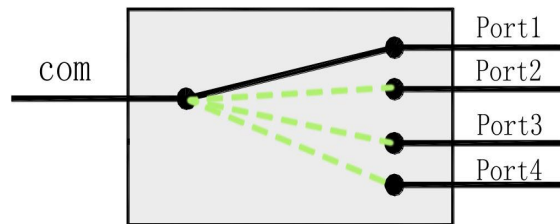

Ordering Information: HC - OSW-A-B-C-D-E-F-G

A	B	C	D	E	F	G
Type	Test Wavelength	Type	Fiber Type	Fiber Dimension	Fiber Length	Connector
Mini 1x4	850: 850nm	3L: Latching	SM: Single Mode	025: $\Phi 0.25\text{mm}$	05: 0.5m	00: None
	1310: 1310nm	3N: Non-latching	M1: Multi-mode 50/125	09: $\Phi 0.9\text{mm}$	10: 1.0m	FP: FC/UPC
	1550: 1550nm	5L: Latching	M2: Multi-mode 62.5/125	X: other	15: 1.5m	FA: FC/APC
	D: 1310/1550nm	5N: Non-latching	X: other		X: other	SP: SC/UPC
	X: other					SA: SC/APC
						LP: LC/UPC
						LA: LC/APC
						X: other